

UAP Duo Door Handle

243mm Long Backplate Stainless Steel



Tube handle gives a very comfortable grip when operating

Made from high grade stainless steel

Tube shaped design with comfortable grip

No grub screw

Dual functionality

Fixed cassette design

What is The Long Backplate UAP DUO Front Door Handle

The DUO door handle has a lever that is curved to the door, making it compliant to DDA (Disability Discrimination Act) regulations, making it ideal for applications where aesthetics and compliance are key. As the DUO handle is not BSI Kitemarked, we recommend fitting the Kinetica 3* Kitemarked Euro Cylinder with it in order to achieve a 3* Kitemark status for PAS 24 doors.

The UAP DUO Front Door Handle

The DUO door handle has a 243mm long backplate and is aimed at the fabricator who wants to offer a high-quality designed door handle. The DUO door handle has a tube-shaped handle, which gives a very comfortable grip when operating.

As the DUO handle suits all needs - working as an attractive high quality lever handle whilst being DDA/EA compliant – it allows fabricators to carry just one handle in stock to satisfy a number of different applications.

Handle complies with DDA/EA regulations

Has a 243mm long backplate

Each handle comes with a LIFETIME coating guarantee!

Tube handle gives a very comfortable grip when operating

Salt spray tested to ASTM B117 for 2,000 hours

Available in 5 finishes

Finishes	Internal Frame Code	Material Construction	Coating Guarantee
PVD Gold	DH243-DUO-PVDG-NANOCOAST	Stainless Steel	LIFETIME
Mirror Polished	DH243-DUO-MPSS-NANOCOAST	Stainless Steel	LIFETIME
Satin Stainless	DH243-DUO-SSS-NANOCOAST	Stainless Steel	LIFETIME
Black	DH243-DUO-BLACK-NANOCOAST	Stainless Steel	LIFETIME
White	DH243-DUO-WHITE-NANOCOAST	Stainless Steel	LIFETIME

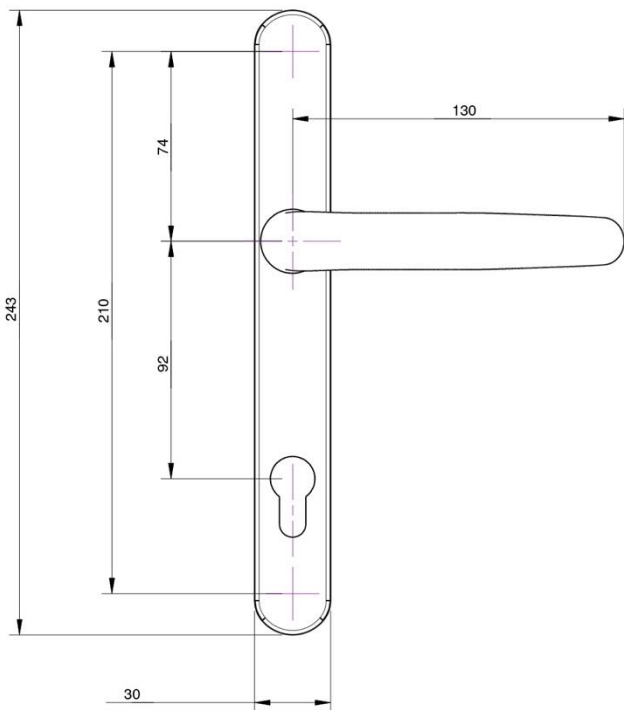

Measurements	
Door Handle Length	243mm
Door Handle Centres	92mm
Distance Between Screw Holes	210mm
Lever Length	130mm
Lever Protrusion	73mm
Backplate Width	30mm