

# Sash Lock Pack

## Firemongery Range

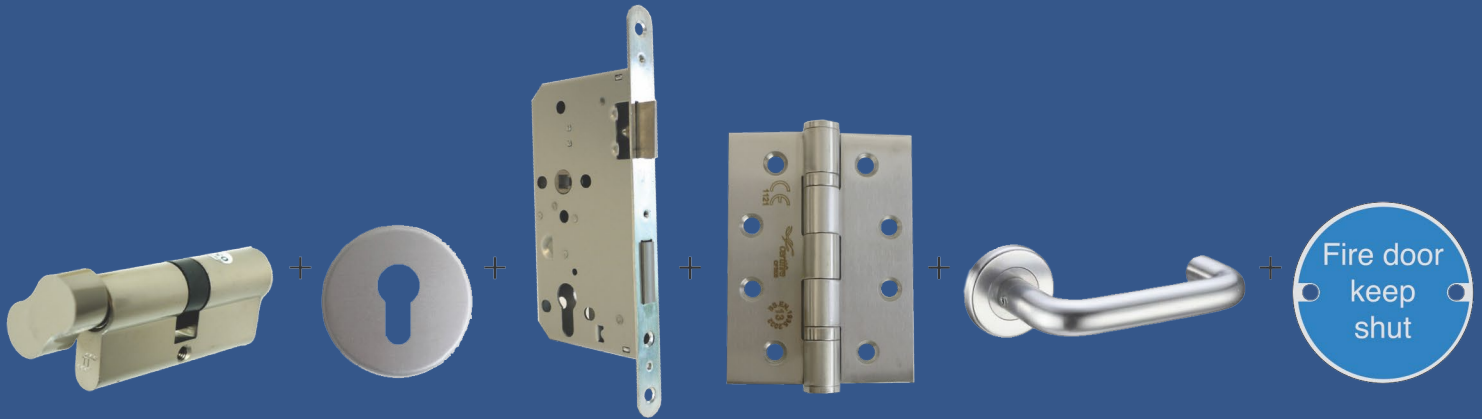

Fire rated,  
complete with  
fixings

Complete set for  
sash lock  
installation

CE Marked Lock  
and hinges

Lever operated  
with euro cylinder



### What is the Firemongery Range?

Finding the right products for fire doors is critical, as it can save lives. Firemongery® is a quick and fool proof way to select fully compliant ironmongery for fire doors.

Pack includes:

- Hinges
- Lever Handle
- Europrofile Sash Lock
- Cylinder
- Escutcheon
- Fire Sign



Product	Description	Finish	Code	QTY.
Hinges	100x76mm Ball Bearing	SSS	IH-HINGE-SS201-FIRE-SQUARE-SSS	3
Lever Handle	19mm RTD Lever on Rose	SSS	IH-C-54.608.19.SSS	1
Europrofile Sashlock	Din Standard Lockcase	SSS	LL-11.861.SSS	1
Cylinder	70mm Cylinder & Turn	SSS	TL35T/35N	1
Escutcheon	Euro Profile Escutcheon	SSS	IH-C-51.608.3.SSS	2
Fire Sign	Fire Door Keep Shut	SSS	IH-FIRE.DOOR.KEEP.SHUT.SIGN.SS	2

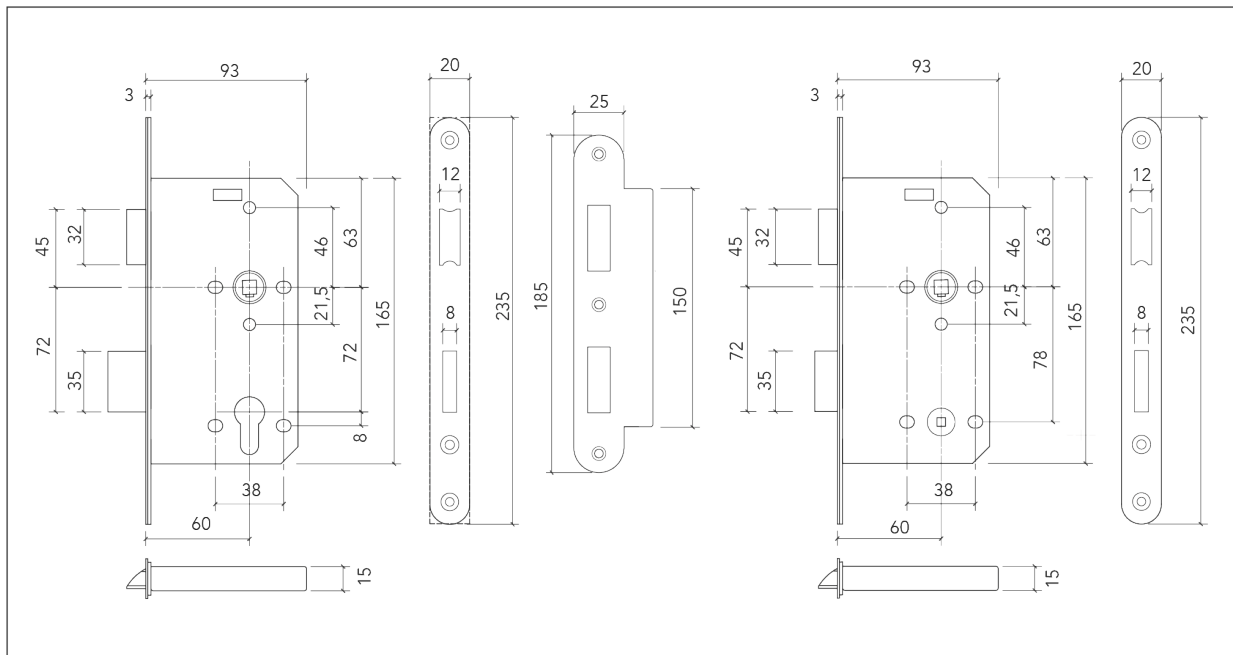

#### User information:

This cylinder offers resistance to many types of attack. It is designed to be used in conjunction with two-star security door hardware to ensure enhanced resistance to all commonly used attack methods. Therefore, this product **MUST** be used in conjunction with two-star security door hardware meeting TS 007 to ensure security. Such hardware can be recognised by the two-star marking which may either be visible from the outside on an installed handle or, failing this, will be visible once the outside handle has been removed. Security hardware can be of several types, including a handle with a reinforced backplate, an escutcheon or a device which is concealed behind the handle backplate. In all cases, the purpose is to protect your cylinder from force attack.